

REV.	DESCRIPTION	DATE	DRAWN	APPROVED
A1	DWG.REL	2015.3.12	FANG	YANG

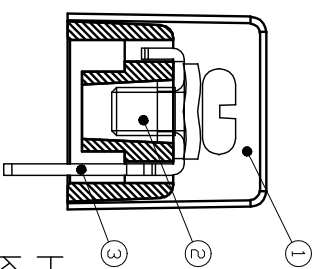
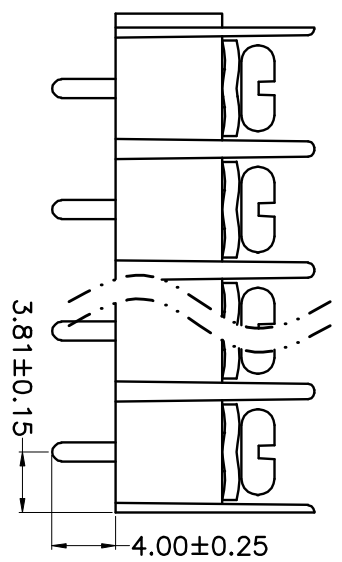
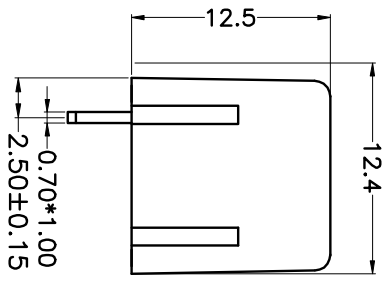
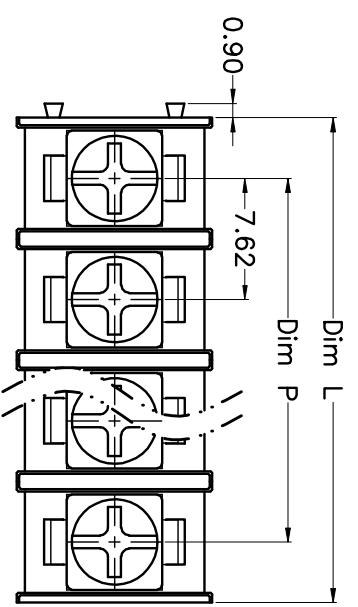

- Material
  - ØHousing : PA66,UL94V-0
  - ØScrews : M3 steel, Ni plated
  - ØTerminal : Brass, Tin plated
- Electrical
  - UL IEC
  - Rated voltage : 300V 450V
  - Rated current : 20A 24A
  - Insulation resistance: 500MΩ/DC500V
  - Withstanding Voltage : AC2000V/1min
  - Wire range: 22-14AWG 2.5mm<sup>2</sup>

- Mechanical
  - Operating temperature: -40°C to +105°C
  - Soldering temperature: 250°C±5/5sec
  - Torque: 0.5N.m (4.43lb.in)

### HOW TO ORDER

KF-762-7.62-XXP-1 X-XXXXXX

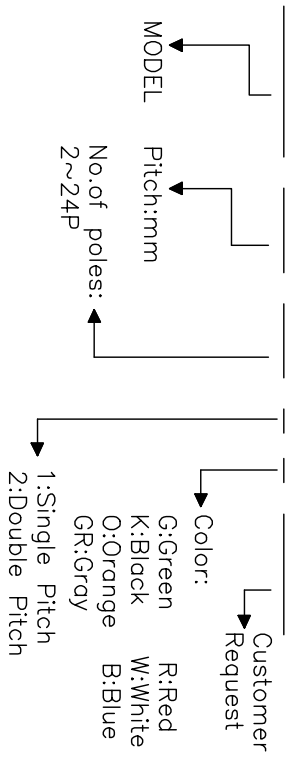

N=Number of Poles  
Dim P=(N-1)X7.62  
Dim L=NX7.62

Poles	Dim	Dim P	Dim L
2-6P		±0.10	±0.15
7-12P		±0.20	±0.20
13-18P		±0.25	±0.30
19-24P		±0.30	±0.40

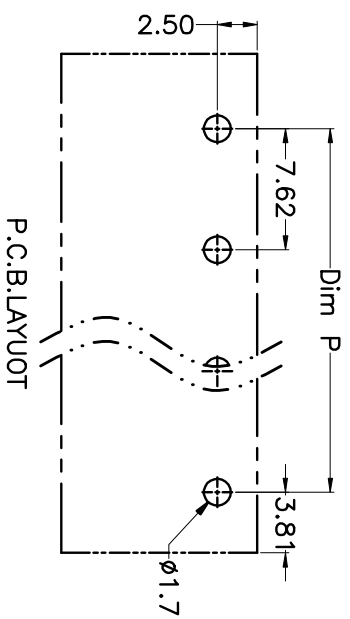

P.C.B.LAYUOT

GENERAL TOLERANCE		ANGLE TOLERANCE	
X.	±0.5	X.	±5°
.X	±0.3	.X	±3°
.XX	±0.1	.XX	±1°
DRAWING TYPE	CUSTOMER		
SCALE	1:1	SHEET	1 OF 1
DRAWING NO.			

PROJECTION	TITLE
mm	KF-762-7.62-XXP
SHEET SIZE	SERIES
A4	KF-762

# 科奕科技有限公司