

| REV. | DESCRIPTION | DATE      | DRAWN | APPROVED |
|------|-------------|-----------|-------|----------|
| A1   | DWG.REL     | 2015.3.12 | FANG  | YANG     |

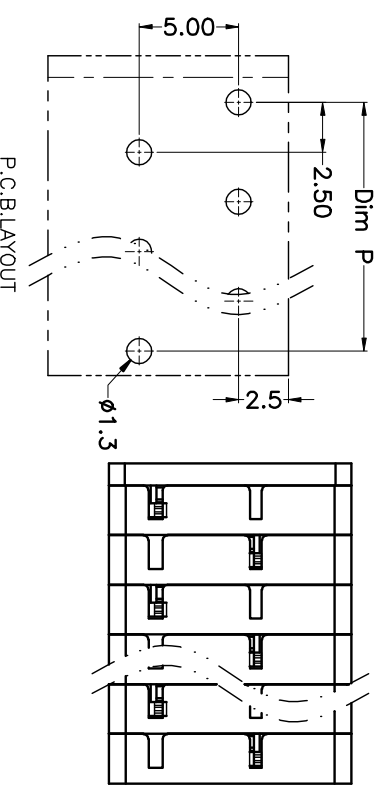
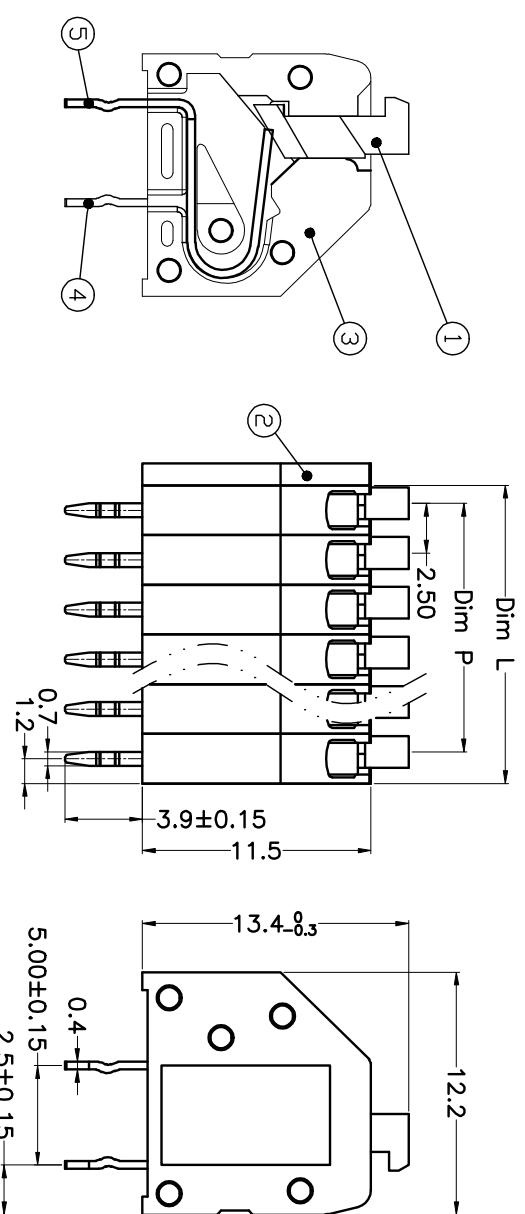
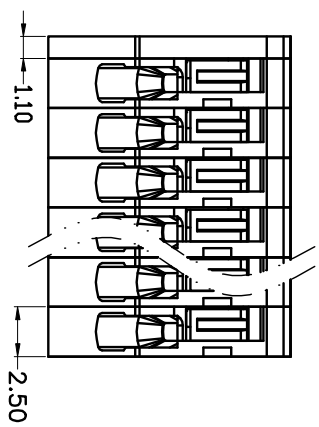

N=Number of Poles  
Dim P=(N-1)x2.5  
Dim L=Nx2.5

| Poles  | Dim P | Dim L |
|--------|-------|-------|
| 2-6P   | ±0.10 | ±0.15 |
| 7-12P  | ±0.20 | ±0.20 |
| 13-18P | ±0.25 | ±0.30 |
| 19-24P | ±0.30 | ±0.40 |

| GENERAL TOLERANCE |      | ANGLE TOLERANCE |     |
|-------------------|------|-----------------|-----|
| X.                | ±0.5 | X.              | ±5' |
| .X                | ±0.3 | .X.             | ±3' |
| .XX               | ±0.1 | .XX.            | ±1' |

| DRAWING TYPE | CUSTOMER | SHEET | OF |
|--------------|----------|-------|----|
| SCALE        | 1:1      | 1     | 1  |

DRAWING NO.

| PROJECTION     | TITLE  |
|----------------|--------|
| UNITS          | mm     |
| SHEET SIZE     | A4     |
| SERIES         | KF250B |
| KF250B-2.5-XXP |        |

### HOW TO ORDER

KF250B-2.5-XXP-1 X-XXXXXX

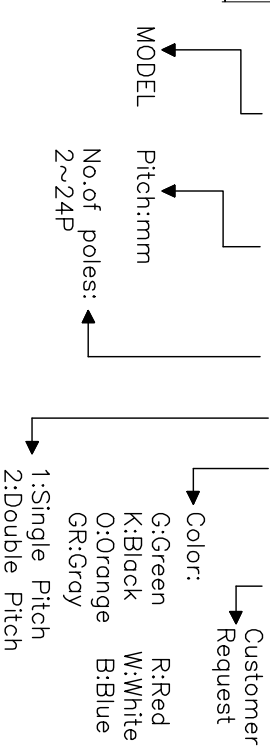

- Material
  - @Button : PA66, UL94V-0
  - @Cover : PA66, UL94V-0
  - @Housing : PA66, UL94V-0
  - @Pin header A: Phosphor bronze or Brass, Tin plated
  - @Pin header B : Phosphor bronze or Brass, Tin plated

- Electrical
  - UL IEC
  - Rated voltage : 300V 250V
  - Rated current : 7A 6A
  - Insulation resistance: 500MΩ/DC500V
  - Withstanding Voltage : AC2000V/1min
  - Wire range: 24-18AWG 0.5mm<sup>2</sup>

- Mechanical
  - Operating temperature: -40°C~+105°C
  - Soldering temperature: 250°C±5/5sec
  - Strip length: 8-9mm

# 科奕科技有限公司