

REV.	DESCRIPTION	DATE	DRAWN	APPROVED
A1	DWG.REL	2015.3.12	FANG	YANG

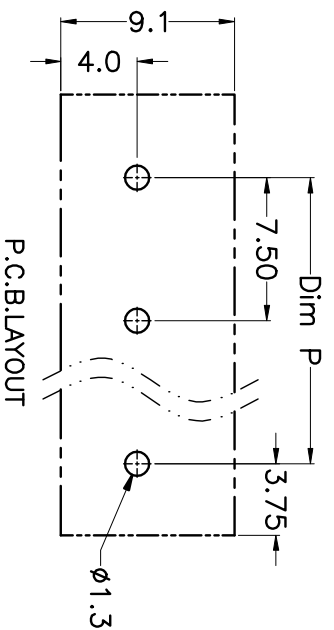
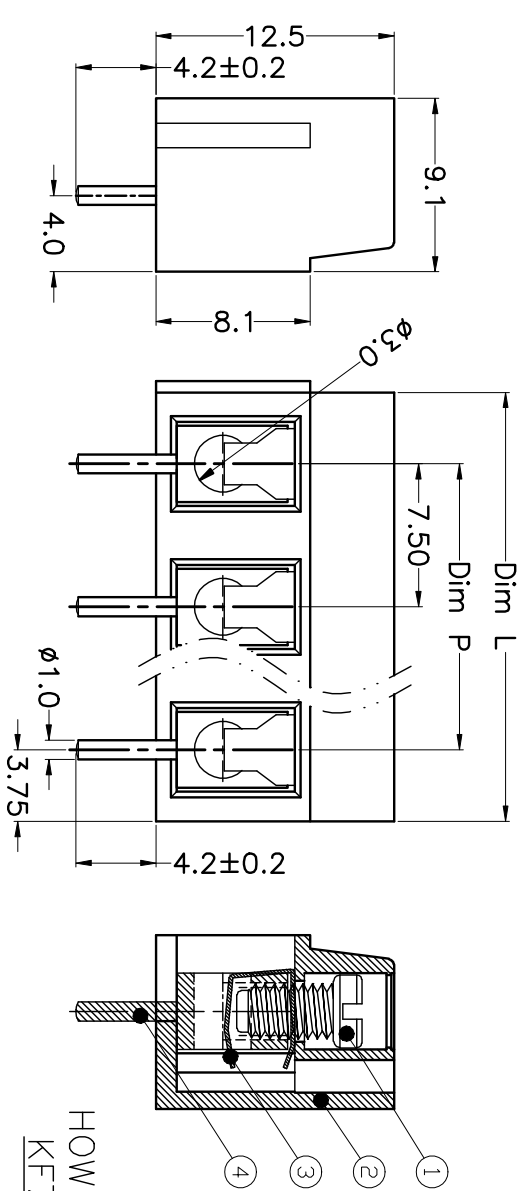
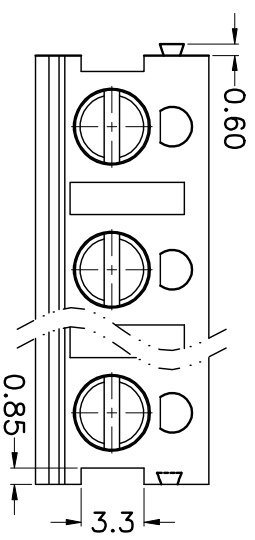

N=Number of Poles  
 Dim P=(N-1)x7.50  
 Dim L=Nx7.50

Poles	Dim P	Dim L
2-6P	±0.10	±0.15
7-12P	±0.20	±0.20
13-18P	±0.25	±0.30
19-24P	±0.30	±0.40

GENERAL TOLERANCE		ANGLE TOLERANCE	
X	±0.5	X	±5°
X	±0.3	X	±3°
.XX	±0.1	.XX	±1°

DRAWING TYPE	CUSTOMER	SHEET	1 OF 1
SCALE	1:1		
DRAWING NO.			

- Material
  - ⊙Screws : M3.0 steel, Zinc plated,
  - “\_” slot type
  - ⊙Housing : PA66, UL94V-0
  - ⊙Reed : Phosphor bronze, Ni plated or stainless steel
  - ⊙Pin header : Brass, Tin plated

- Electrical
  - UL IEC
  - Rated voltage : 300V 450V
  - Rated current : 12A 24A
  - Insulation resistance: 500MΩ/DC500V
  - Withstanding Voltage : AC2500V/1min
  - Wire range: 22-14AWG 2.5mm<sup>2</sup>

- Mechanical
  - Operating temperature: -30°C ~ +120°C
  - Soldering temperature: 250°C ±5 / 5sec
  - Torque: 0.5N.m (4.43lb.in)
  - Strip length: 4.5-5mm

### HOW TO ORDER

KF705 V - 7.5 - XXP - 1 X - XXXXX

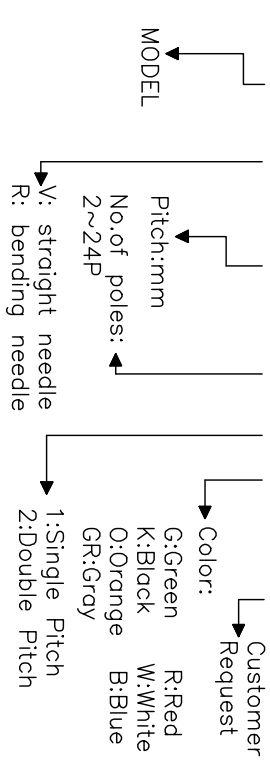

PROJECTION	TITLE
UNITS	KF705V-7.5-XXP
SHEET SIZE	A4
SERIES	KF705V

# 科奕科技有限公司